

SEP 28 11 14 AM 1960

OLLIE ... NORTH

G. W. LYNN

G. W. LYNN

S. 21° 40' E  
100

0.50 ACRE

N. 18° 20' E  
217.2

S. 20° 00' W  
100

JAMES ...

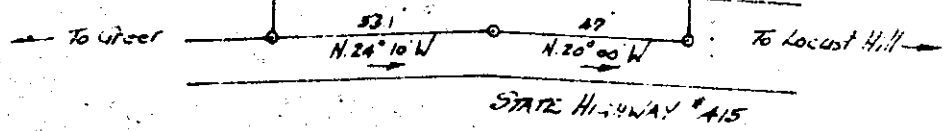

PROPERTY OF  
GEORGE M. LYNN

Located approx 7 miles North of Ureer.  
ONEAL TOWNSHIP GREENVILLE COUNTY  
SOUTH CAROLINA.

SCALE: 1" = 40 FEET

FEB 10 1960

H. S. BROCKMAN, Reg Surveyor #457  
JOHN A. SIMMONS, " #2212  
UREER, S. C.

SEP 28 1960

S579

Photo 100 Recorded September 28, 1960 at 11:14 A. M. #8579